

Pronounced style, classic design

Where simplicity and luxurious lifestyles meet

Our 1A88 allows you to utilize your furniture elegantly without any effort. The push-open design will completely change your views about drawers. Without the handle bar your furniture can keep its fine appearance and more stylish look can be achieved. The 1A88 employs our meticulously developed hydraulic dampers to provide long lifespan and better performance. The hydraulic dampers also bring about a smoother and quieter drawer operation. After all, you would no longer be afflicted by squeaky/hard to operate drawers. The 1A88 is the hidden foundation in life that you deserve.

The World's First Electric-Free All-Mechanical Design

King Slide flawlessly combined the touch-to-open and soft-closing technologies in 1A88. Unlike other brands, King Slide uses all-mechanical patent pending design that will not only save electricity but also promote green technology. With King Slide's all-mechanical design, 1A88 concocts your personal style and green life!



1A88

**Push-Open with Silent Soft-Closing
Undermount Slide**

Awarded Prizes



Best of KBIS: Best of Kitchen Gold Award

The Kitchen & Bath Industry Show (KBIS) is the world's largest international trade event that focuses specially on all aspects of kitchens and baths. The winners of the 2010 Best of KBIS Competition announced at the show highlight exceptional products introduced in the past 12 months for their functionality, quality, flexibility, aesthetics, style and innovation.



IWF 2010 Challengers Award® Winner

The IWF Challengers Award® is widely known as the woodworking industry's highest honor, recognizing advancements in technologies or significant contributions to environmental improvements. The award challenges IWF exhibiting companies to develop revolutionary, ingenious and forward-thinking technologies, materials and safety devices that advance the industry.



TAIWAN Excellence 2011

Taiwan Excellence is the highest accolade awarded to products that encapsulate innovation. Taiwan Excellence winners represent the most revolutionary, high quality, high value added products/designs made by Taiwan.

Operation Manual

Way 1.

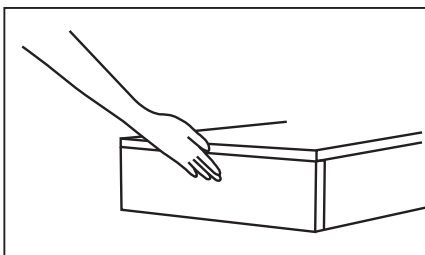

A) Press the Drawer Front

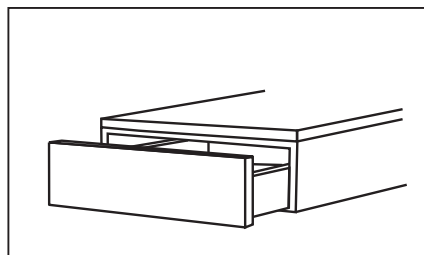

B) Drawer Opens Automatically via Mechanism

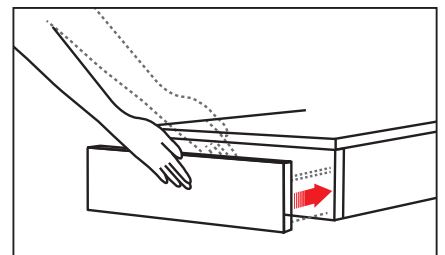

C) Press to Close the Drawer

Way 2.

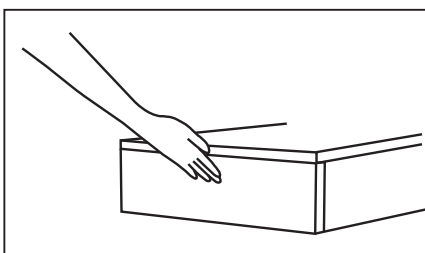

A) Press the Drawer Front

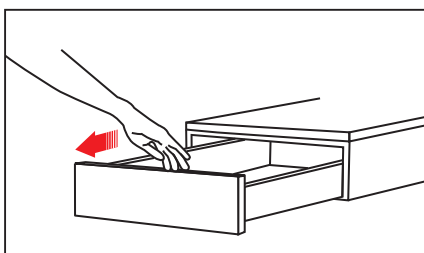

B) Pull the Drawer for Your Use

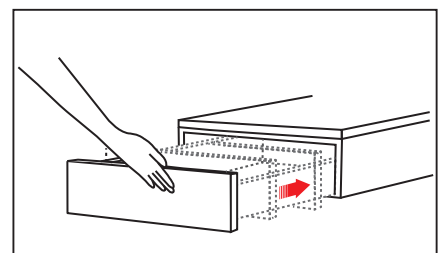

C) Silent Soft-Closing

1A88

Push-Open with Silent Soft-Closing
Undermount Slide (16mm)



Specifications

- **Length:** 250mm to 550mm
- **Travel:** Full Extension
- **Maximum Drawer Side Thickness:** 16mm
- **Max. Load Capacity:** 34 kg (75 lb) /pair
- **Mount:** Undermount
- **Material:** Galvanized Steel
- **Packing:** Unit Packed in 2 pairs/carton
6 pairs/carton

Features

- Push-open, handle-free.
- Enhanced silent soft-closing feature with light opening force
- Durable damping system with fast response capability
- All mechanical device, instead of electric-driven
- Safe, user-friendly and energy saving
- Undermount with full extension travel length
- Ultra smooth gliding motion with high rigidity and stability design
- Ergonomic trimming system provides tool-less height and depth adjustments
- A tool-less adjustment system is available to permit minor installation inaccuracies, thereby reducing assemblage complexity.
- Effortless assembly and removal of drawer with front release lever
- High installation allowances for drawer width: +0.5/-1mm, and for drawer depth: +1/-1mm



Applications

- For Frameless Cabinet : Kitchen Furniture, Kitchen Cabinetry, Home Cabinetry and Box Drawers

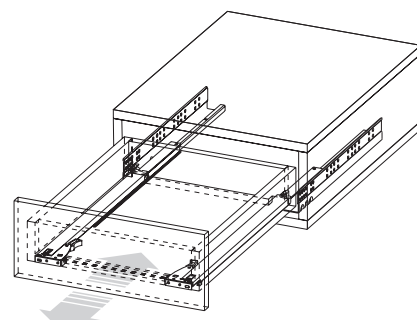

Dimension Specifications

Cabinet Holes Position

- Red Dots : Minimum Screw Required
- Note: Ensure the slide is parallel to the horizon or tilt to cabinet front on both sides during installation.

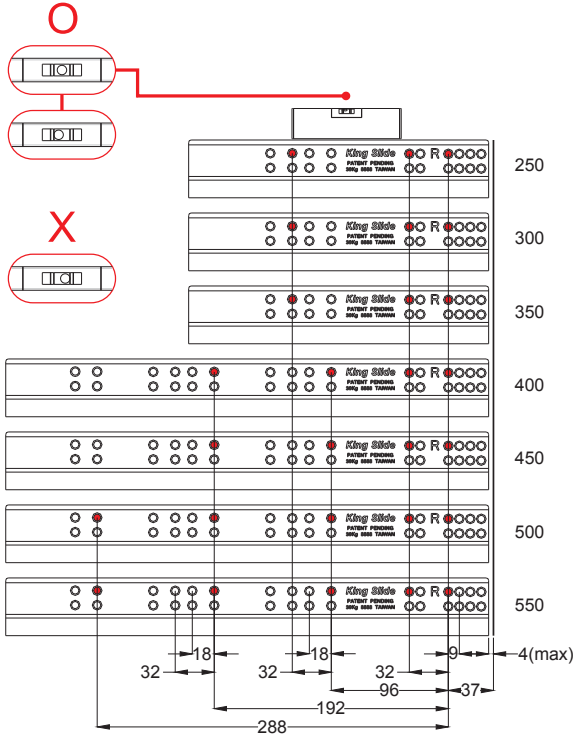

○		X
Chipboard Screws	System Screws	Round Head Screw

Space Requirement

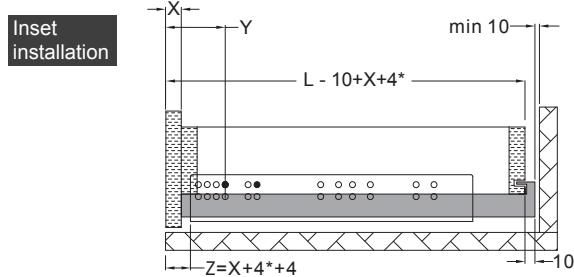
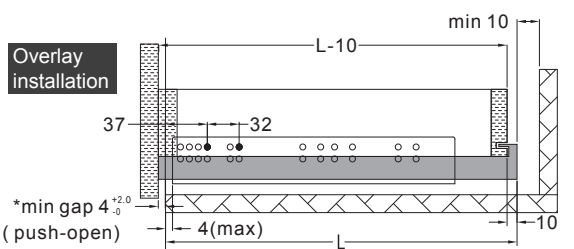
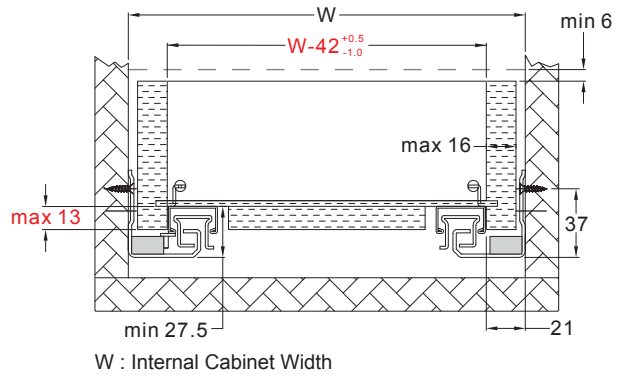

	x	18	19	20	21	22	23	24
Y		59	60	61	62	63	64	65
Z		26	27	28	29	30	31	32

L: Slide Length X: Front Panel Thickness

Note: Holes other than those shown may be in the slide member at King Slide's option and may change without notice.

Item No.	Total Length (mm)	Slide Travel (mm)	Self-Closing Travel (mm)	Loading Capacity kg(lb) / pair
1A88-250	250	224	30	34 (75)
1A88-300	300	280	30	34 (75)
1A88-350	350	340	30	34 (75)
1A88-400	400	390	45	34 (75)
1A88-450	450	440	45	34 (75)
1A88-500	500	490	45	34 (75)
1A88-550	550	540	45	34 (75)

Easy Assembly with Front-End Installation

Tool-Less Height Adjustment :
Simply rotate the wheel at the front bottom of the drawer to adjust the drawer height

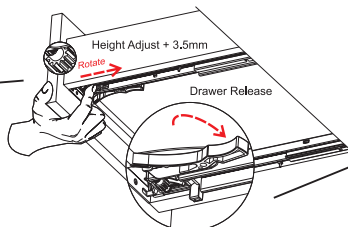

Drawer Removal:
Simply press the front release device to remove the drawer

1B88

Push-Open with Silent Soft-Closing Undermount Slide (19mm)



Specifications

- **Length:** 250mm to 550mm
- **Travel:** Full Extension
- **Maximum Drawer Side Thickness:** 19mm
- **Max. Load Capacity:** 34 kg (75 lb)/pair
- **Mount:** Undermount
- **Material:** Galvanized Steel
- **Packing:** Unit Packed In 2 pairs/carton
6 pairs/carton

Features

- Push-open, handle-free
- Enhanced silent soft-closing feature with light opening force
- Durable damping system with fast response capability
- All mechanical device, instead of electric-driven
- Safe, user-friendly and energy saving
- Undermount with full extension travel length
- Ultra smooth gliding motion with high rigidity and stability design
- Ergonomic trimming system provides tool-less height and depth adjustments
- A tool-less adjustment system is available to permit minor installation inaccuracies, thereby reducing assemblage complexity.
- Effortless assembly and removal of drawer with front release lever
- High installation allowances for drawer width: +0.5/-1mm, and for drawer depth: +1/-1mm

Applications

- For Frameless Cabinet : Kitchen Furniture, Kitchen Cabinetry, Home Cabinetry and Box Drawers

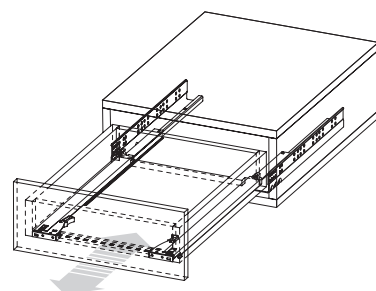

Dimension Specifications

Cabinet Holes Position

- Red Dots : Minimum Screw Required

Note: Ensure the slide is parallel to the horizon or tilt to cabinet front on both sides during installation.

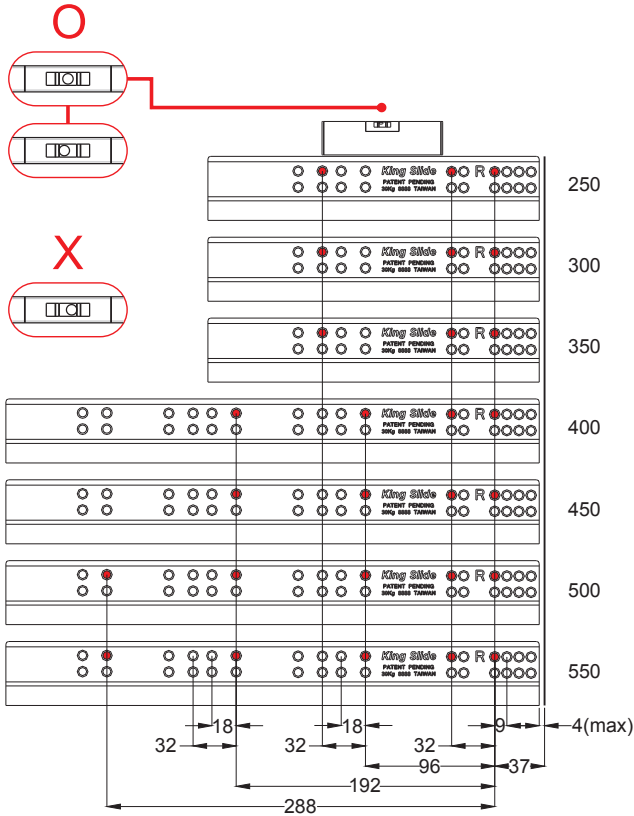

Note: Holes other than those shown may be in the slide member at King Slide's option and may change without notice.

Space Requirement

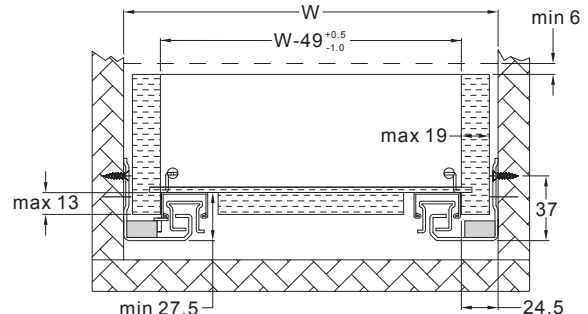

W : Internal Cabinet Width

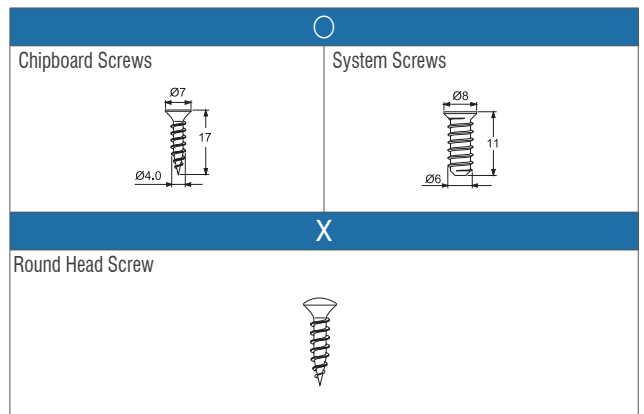

Item No.	Total Length (mm)	Slide Travel (mm)	Self-Closing Travel (mm)	Loading Capacity kg(lb) / pair
1B88-250	250	224	30	34 (75)
1B88-300	300	280	30	34 (75)
1B88-350	350	340	30	34 (75)
1B88-400	400	390	45	34 (75)
1B88-450	450	440	45	34 (75)
1B88-500	500	490	45	34 (75)
1B88-550	550	540	45	34 (75)

Easy Assembly with Front-End Installation

Tool-Less Height Adjustment :
Simply rotate the wheel at the front bottom of the drawer to adjust the drawer height

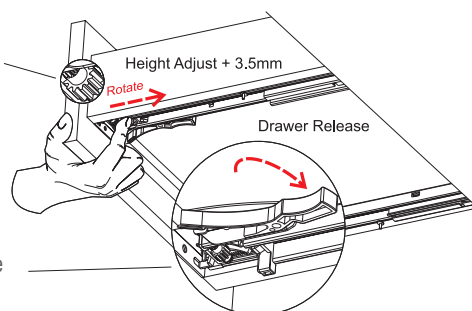

Drawer Removal:
Simply press the front release device to remove the drawer

Our specially designed front-end installation allows quick and simple drawer installation and removal processes. The quick connect and disconnect device is located at the front-end under the drawer, keeping intact the elegant appearance of the drawer.

Installation Instruction

1A88 & 1B88

1. Before installing the slides, make sure the dimensions of the cabinet and drawer meet the requirements specified in Fig. 1 and Fig. 2.
2. Drill holes on the cabinet following the 'Cabinet Holes Position' drawing on the reverse page. Mount the slides on the cabinet using the recommended type of screws.
3. Make cut-outs on the drawer according to Fig. 3A and Fig. 3B's dimension (Using the drill template FLOOZD0-A as page 1.39 is recommended), then install the front release lever according to Fig. 3A.
4. Pull out the slides on the cabinet.

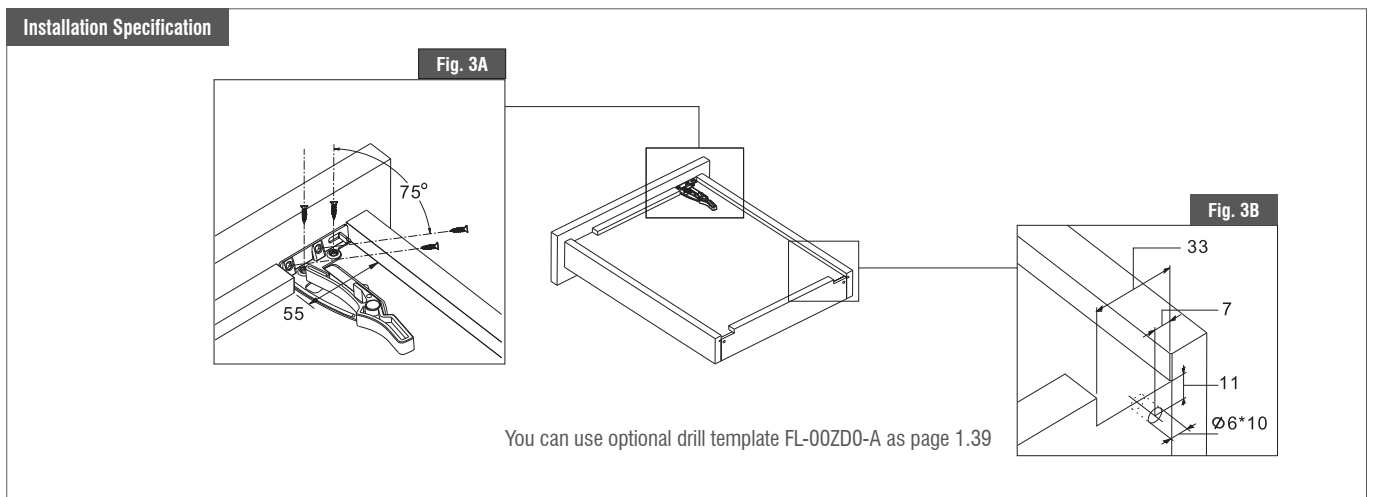
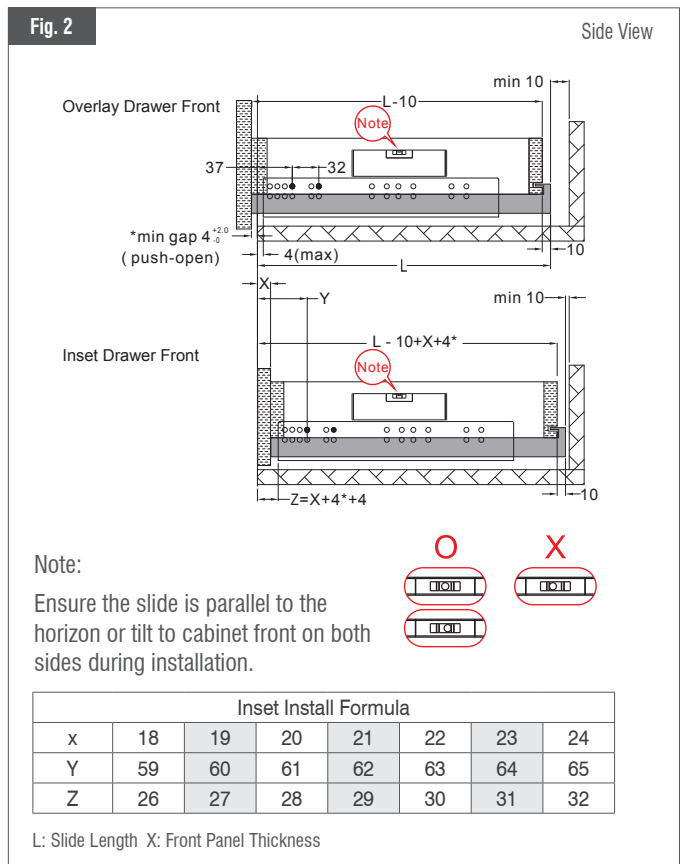
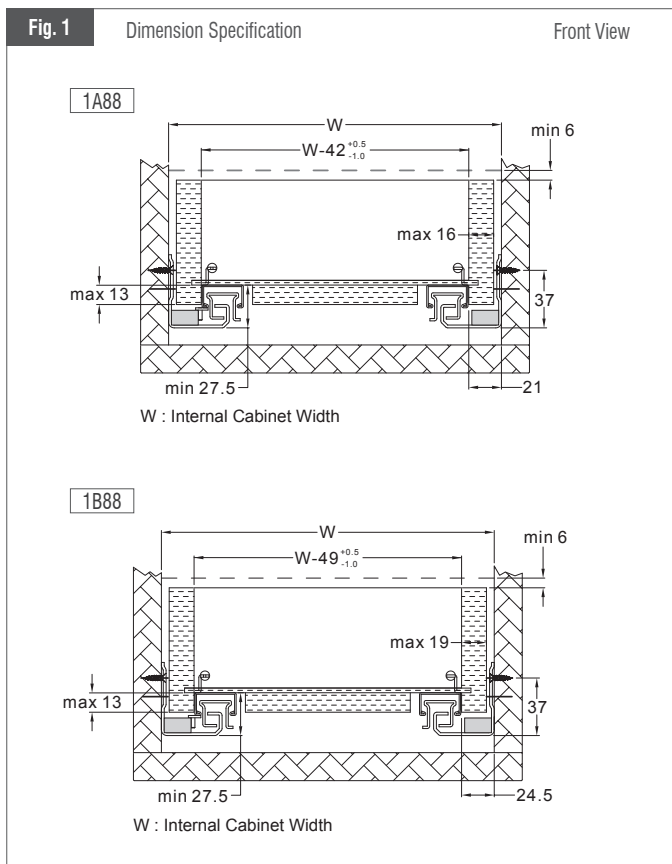

5. Position and align the drawer with the slide as shown in Figs. 4A and 4B. Push the drawer all the way into the cabinet as shown in Fig. 4C until clicked to complete the installation.
6. After confirming the drawer is operating normally, install the front panel.
7. If height / depth adjustment is needed after installation, please refer to the Detail Adjustment Info. below or the feature diagram on the previous page.

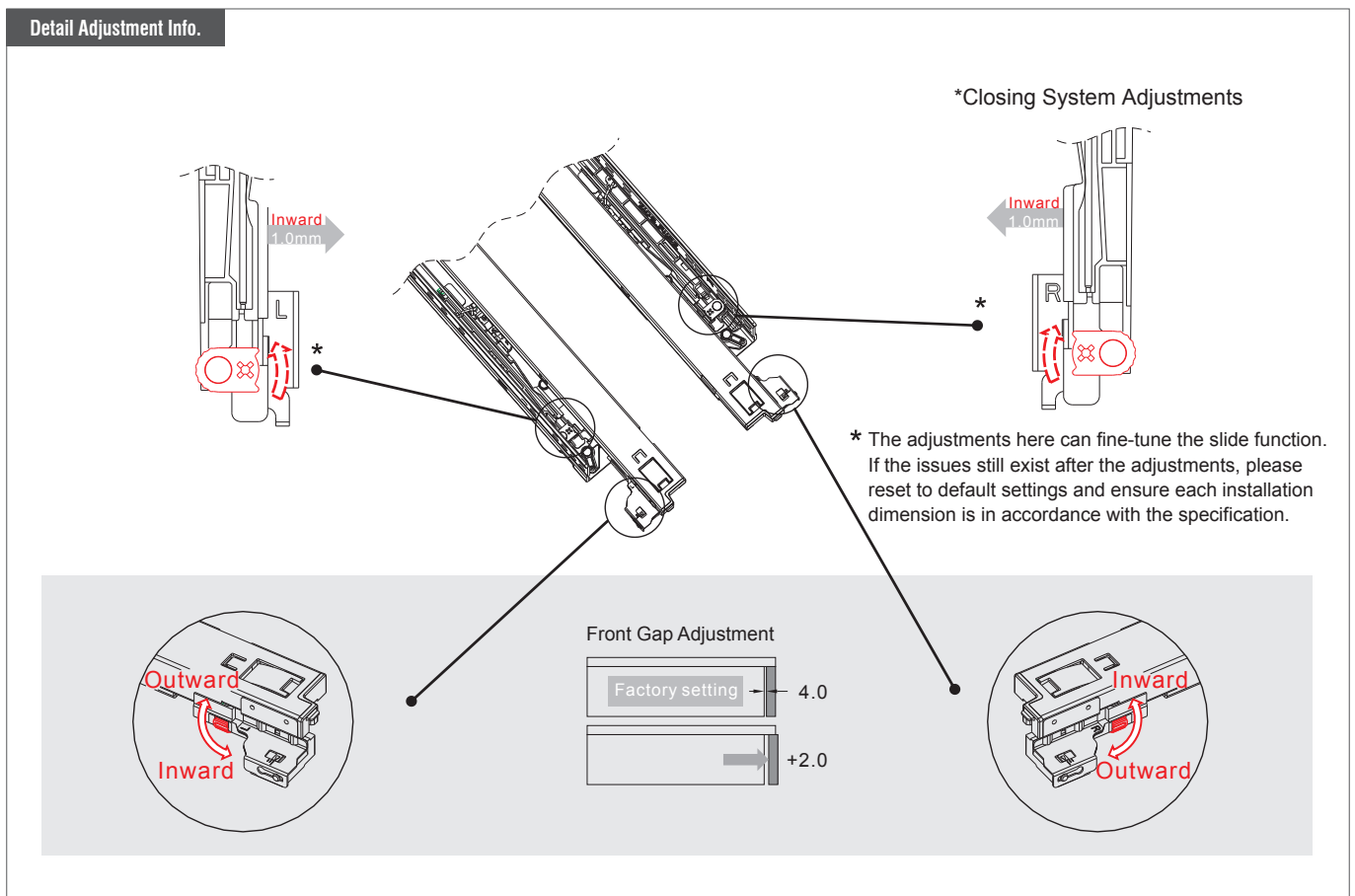
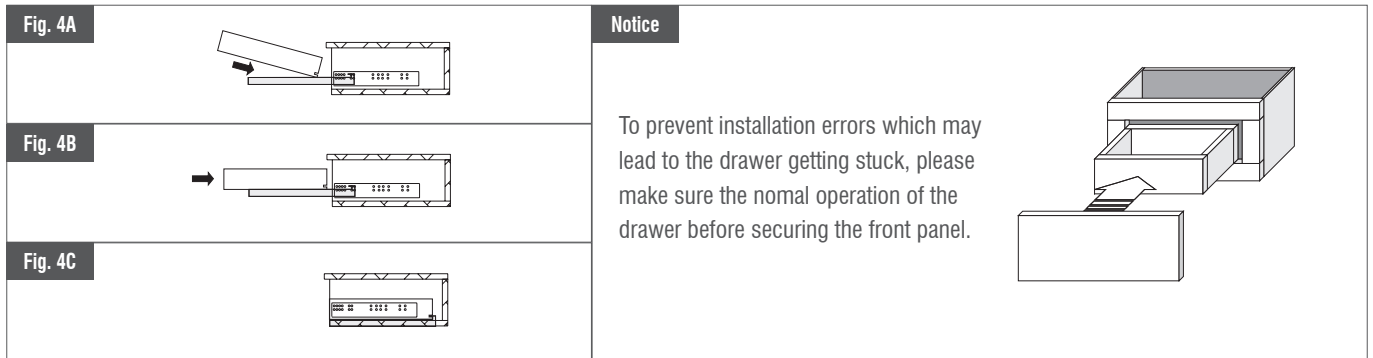

Notes for installation

1. Ensure the drawer body appearance is upright. It could not be diamond trapezoidal or distorted!
2. Ensure the side space, depth on both sides are consistent.
3. Ensure the installation location or the cabinet is on a flat surface.
4. Ensure the front release lever is installed correctly.
5. Ensure the drawer dimensions, rear notch locking hole, internal drawer width, and the drawer bottom recess are correct.

1B88F

Push-Open with Silent Soft-Closing
Undermount Slide for Face Frame Cabinet
(19mm)



Specifications

- **Length:** 305 / 381 / 457 / 533mm
12" / 15" / 18" / 21"
- **Travel:** Full Extension
- **Maximum Drawer Side Thickness:** 19mm
- **Max. Load Capacity:** 34 kg(75 lb)/pair
- **Mount:** Undermount
- **Material:** Galvanized Steel
- **Packing:** Unit Packed in 2 pairs/carton
6 pairs/carton

Features

- Push-open, handle-free
- Enhanced silent soft-closing feature with light opening force
- Durable damping system with fast response capability
- All mechanical device, instead of electric-driven
- Safe, ergonomic and energy saving
- Undermount with full extension travel length
- Ultra smooth gliding motion with high rigidity and stability design
- 2 dimensional trimming system provides tool-less height and depth adjustments
- A tool-less adjustment system is available to permit minor installation inaccuracies, thereby reducing assemblage complexity.
- Effortless assembly and removal of drawer with front release lever
- High installation allowances for drawer width: +0.5/-1mm, and for drawer depth: +1/-1mm

Applications

- For Face Frame Cabinet : Kitchen Furniture, Kitchen Cabinetry, Home Cabinetry and Box Drawers

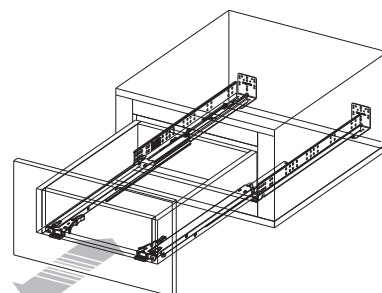

Space Requirement

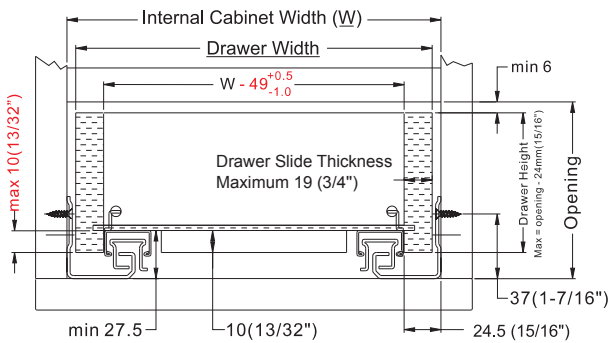

Drawer Width Formula	
Drawer Side Thickness mm (inch)	"W" minus mm (inch)
19 (3/4")	11 (7/16")
18 (23/32")	13 (1/2")
17 (21/31")	15 (19/32")
16 (5/8")	17 (21/32")
15 (19/32")	19 (3/4")

W: Internal Cabinet Width

Example:

Internal Cabinet Width = 457 mm (18")

Drawer Side Thickness = 19 mm (3/4")

Drawer width = $457 - 11 = 446^{+0.5}_{-1.0}$ mm
 = $(18") - (7/16") = 17-9/16"$

Dimension Specifications

Note: Holes other than those shown may be in the slide member at King Slide's option and may change without notice.

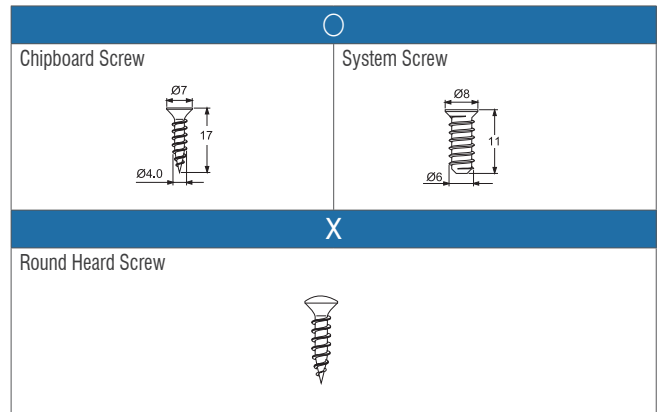
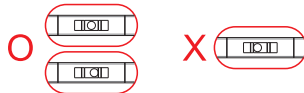
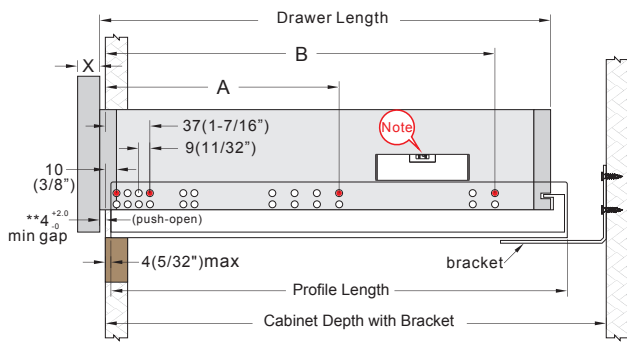

Note:
 Ensure the slide is parallel to the horizon or tilt to cabinet front on both sides during installation.

Item No.	Drawer Length mm (inch)	Overall Cabinet Depth mm (inch)	Cabinet Depth With Bracket mm (inch)		Profile Length mm (inch)	System Screw Locations mm (inch)	
			MAX	MIN		A	B
1B88F305	305 (12")	381 (15")	369 (14-9/16")	326 (12-7/8")	318 (12-1/2")	165 (6-1/2")	261 (10-1/4")
1B88F381	381 (15")	457 (18")	446 (17-9/16")	403 (15-7/8")	394 (15-1/2")	165 (6-1/2")	357 (14-1/16")
1B88F457	457 (18")	533 (21")	522 (20-9/16")	479 (18-7/8")	470 (18-1/2")	261 (10-1/4")	453 (17-13/16")
1B88F533	533 (21")	610 (24")	598 (23-9/16")	555 (21-7/8")	546 (21-1/2")	261 (10-1/4")	517 (20-3/8")

Fit with American standard 3" cabinet depth system.

Easy Assembly with Front-End Installation

Tool-less Height Adjustment :

Simply rotate the wheel at the front bottom of the drawer to adjust the drawer height

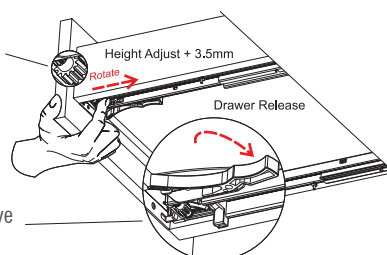

Drawer Removal:

Simply press the front release device to remove the drawer

Our specially designed front-end installation allows quick and simple drawer installation and removal processes. The quick connect and disconnect device is located at the front-end under the drawer, keeping intact the elegant appearance of the drawer.

Installation Instruction

1A88F & 1B88F

1. Before installing the slides, make sure the dimensions of the cabinet and drawer meet the requirements specified in Fig. 1 and 'Space Requirement' drawing respectively for the slide to be installed.
2. Drill holes on the cabinet following the 'Installing Specification' drawing on the reverse page. Mount the slides and the rear brackets on the cabinet using the recommended type of screws.
3. Make cut-outs on the drawer according to Fig. 2A's dimension (Using the drill template FL00ZD0-A as page 1.39 is recommended), then install the front release lever according to Fig. 2B and 2C.
4. Pull out the slides on the cabinet.

Fig. 1 Dimension Specification Front View

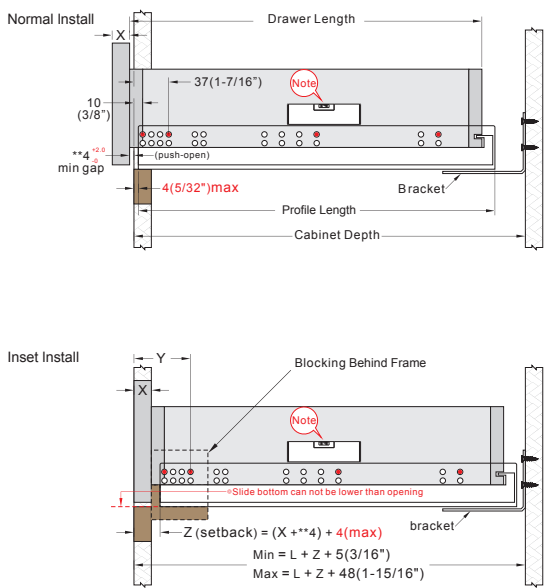

Inset Install Formula							
x	16	17	18	19	20	21	22
Y	57	58	59	60	61	62	63
Z	24	25	26	27	28	29	30

L: Slide Length X: Front Panel Thickness

Note:

Ensure the slide is parallel to the horizon or tilt to cabinet front on both sides during installation.

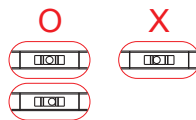

Installation Requirement

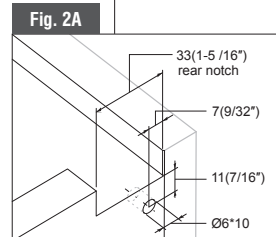
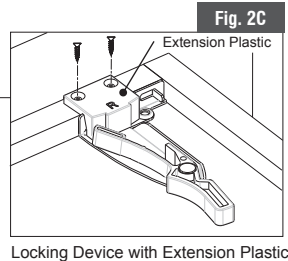
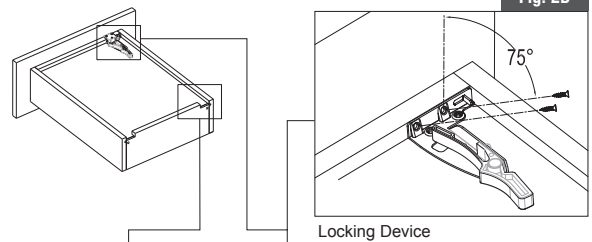

You can use optional drill template FL-00ZD0-A as page 1.39

Rear Bracket

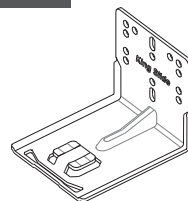

*Minimum 3 screws per bracket

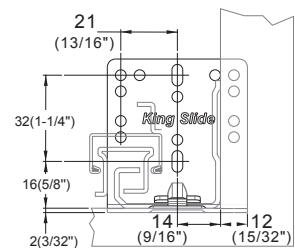

5. Position and align the drawer with the slide as shown in Fig. 3A and 3B. Push the drawer all the way into the cabinet as shown in Fig. 3C until clicked to complete the installation.
6. After confirming the drawer is operating normally, install the front panel.
7. If height / depth adjustment is needed after installation, please refer to the Detail Adjustment Info. below or the feature diagram on the previous page.

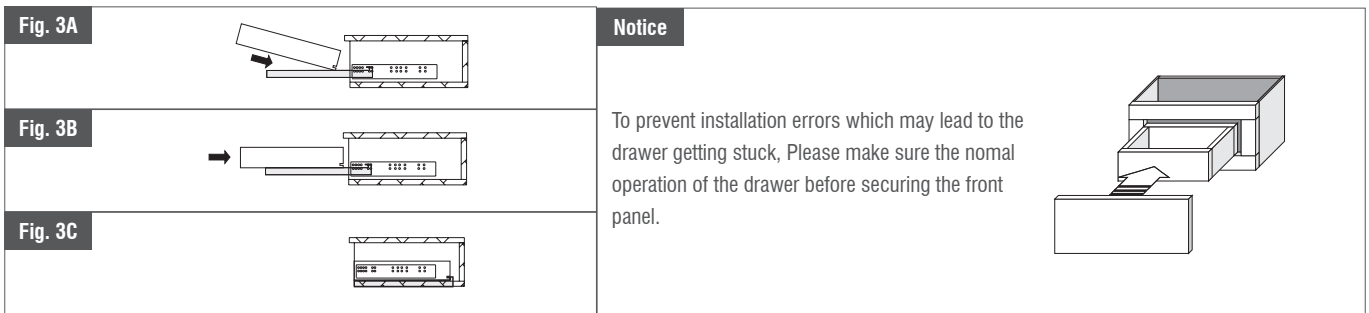
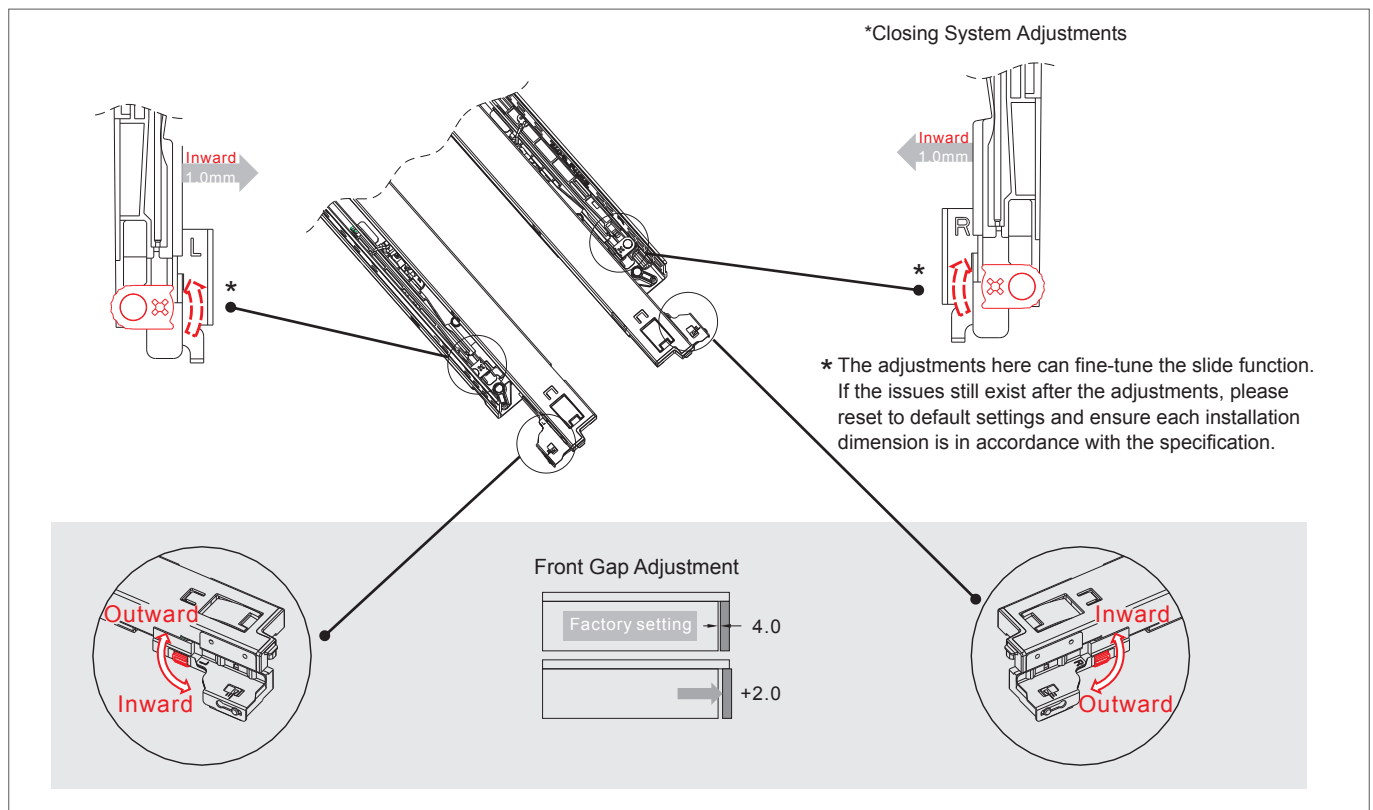
**Detail Adjustment Info****Notes for installation**

1. Ensure the drawer body appearance is upright. It could not be diamond trapezoidal or distorted!
2. Ensure the side space, depth on both sides are consistent.
3. Ensure the installation location or the cabinet is on a flat surface.
4. Ensure the front release lever is installed correctly.
5. Ensure the drawer dimensions, rear notch locking hole, internal drawer width, and the drawer bottom recess are correct.